



## Installation of Desert Aire FreshAire Evacuator Bench System

Unpack Evacuator and check for shipping damage. If there is damage, immediately notify shipper and contact Paddock Evacuator. Confirm that all parts are with shipment according to Packing List. If any parts are missing or you have any questions or concerns, please call 262-946-7400 or email [service@desert-aire.com](mailto:service@desert-aire.com). Please read complete installation guide before beginning actual installation.

### **The Evacuator System Installation will include:**

1. The Evacuator Bench Installation
2. The Exhaust Duct Installation
3. The Desert Aire RecoverAire™ or locally sourced Exhaust Fan Installation
4. System Balance with Existing Mechanical System
5. Owner Training and Project Acceptance Upon Completion

### **Contractor Suggested Materials for Evacuator Bench Installation**

- Measuring Tape
- Hammer Drill
- Cordless/Impact Drill
- 1/4" Masonry Bit
- #3 Phillips Bit
- Caulk Gun
- Blue Painter's Tape
- Chalk Line
- Duct Tape
- Shop-Vac
- Extension Cord(s)

### **Evacuator Bench Installation:**

1. **FreshAire Evacuator must be installed per the Specification Design Drawing.**
2. Locate area for exterior exhaust penetration (wall/roof) as defined on drawing.
3. Place connection box and position for alignment with exhaust penetration. Ensure that this location works as designed.
4. Establish exhaust penetration location according to design solution. Keep in mind that there may be minor job site modifications required for final penetration location.

5. Position connection box base to align with exhaust penetration, making sure open ends of base are aiming toward area where benches will be located.
  - a. **Ensure that the connection box base is level and square to wall.**
  - b. Drill four (4) holes through base (two (2) per concaved “foot” area – equally spaced) with hammer drill using ¼” masonry bit.
  - c. Anchor to floor using four (4) plastic anchors and four (4) 1” stainless steel screws (provided).
6. Place connection box in base by setting one side in the lip and applying pressure to the opposite side while pushing the box down until secure in the bottom of the base. Ensure that male ends of the connection box are facing the correct direction. Do not anchor connection box in place at this time.
7. Place bench bases on floor aligning each end to end. Make sure alignment is straight and square with the wall or columns. **Do not secure the bench base to deck at this point.**
8. Dry fit all benches within bases to assure correct fit and complete system alignment.
  - a. All Benches have a male (right end) and a female (left end) to them. This design allows for multiple bench systems to be connected together.
  - b. Place the bench in the base by setting one side of the bench in the base and applying pressure to the opposite side while pushing the box down until secure in the bottom of the base. This step may require one person at either end of the bench.
  - c. Bench may not fit tight against outside of base. This will be addressed when permanently installed.
  - d. Make sure entire system aligns properly as designed.
9. Once properly aligned per the design drawing, remove the benches from the base and place them safely out of the way to avoid damage and interference with base installation. Leave the bench bases in place.
10. Weep or drain holes are not usually required as water that enters the bench is typically evaporated due to the velocity of the air within the bench. In addition, the higher velocity reduces the opportunity for dust to settle and collect within the duct. For non-typical applications methods for draining water buildup may be added. Ensure any drainage opening are placed as to not cause water damage to surrounding areas.

11. Anchor the bench bases.
  - a. **Ensure that the bench base is level and square to wall.**
  - b. Drill eight (8) holes through base (two (2) per concaved “foot” area – equally spaced) with hammer drill using 1/4” masonry bit.
  - c. Anchor to floor using eight (8) plastic anchors and eight (8) 1” stainless steel screws (provided).
  - d. Repeat above steps for more than one bench base as required in design.
12. At this point, the connection box base(s) and bench bases should be secured to the deck and level.
13. Cut the exhaust duct adapter hole in the connection box. Use a jig saw and fine tooth blade, such as 14tpi or higher. Fasten exhaust duct adapter to connection box. Make sure adaptor hole and exhaust penetration are properly aligned.
14. **Clean all base and bench edges to ensure adhesion of caulk.**
15. Secure connection box in base:
  - a. Apply a bead of marine grade caulk/adhesive (provided) around the inside lip of the base.
  - b. Place connection box in base, wiping off excess caulk leaving a clean smooth surface.
16. Secure Benches in base:
  - a. Apply a bead of marine grade caulk/adhesive (provided) to the inside lip of both sides of the base, and male end of previous bench if required.
  - b. Place bench in the base and slide end over previous bench end. Apply wedges if needed to spread bench flush against base wall. Wedges must be removed after caulk sets (30 minutes). This may cause a delay in installing additional benches.
  - c. Wipe off excess caulk leaving a clean smooth surface.
17. Install provided End Caps
  - a. Apply a bead of marine grade caulk/adhesive (provided) around the lip of the male end (either bench or end cap).
  - b. Place end cap wiping off excess caulk leaving a clean smooth surface.
18. Install plastic molding pieces on front of bases and around connection box base, cutting to length as needed.

19. Caulk seam between bench and top of plastic molding.
20. Finish bench installation by applying caulk between bench joints as follows:
  - a. Using blue painters tape, apply tape to both sides of joint.
  - b. Apply caulk to joints with appropriate tip - attempt to keep caulk joints small and narrow to assure clean finish.
  - c. Smooth caulk joint with finger. Applying a household cleaner (e.g. Windex) to wet fingertip will make joints cleaner and smoother.
  - d. **A clean, smooth caulk finish is essential to a good looking finished product.**

EVAC-SGL-L

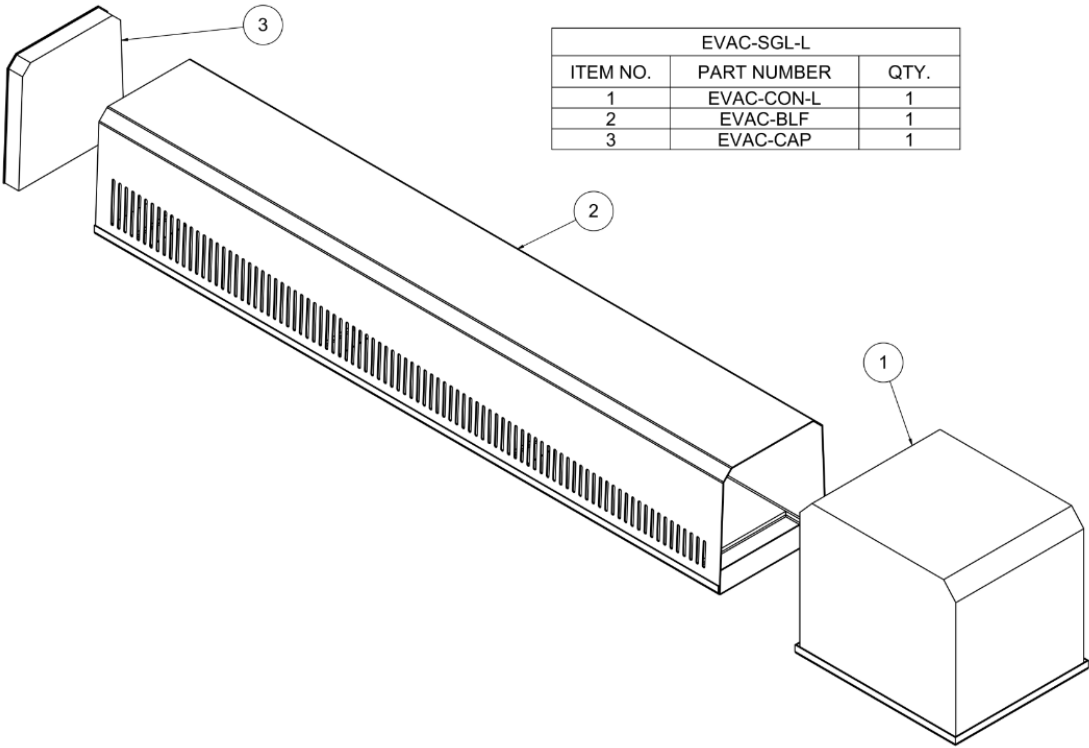

EVAC-SGL-L		
ITEM NO.	PART NUMBER	QTY.
1	EVAC-CON-L	1
2	EVAC-BLF	1
3	EVAC-CAP	1

EVAC-SGL-R

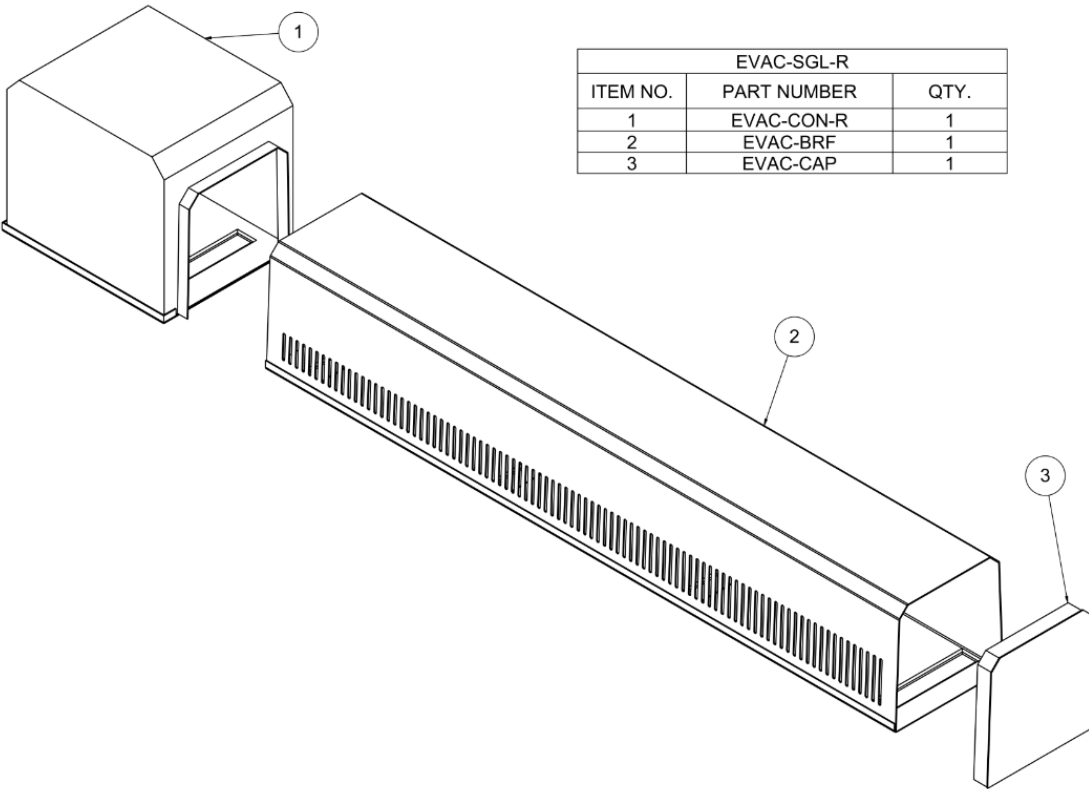

EVAC-SGL-R		
ITEM NO.	PART NUMBER	QTY.
1	EVAC-CON-R	1
2	EVAC-BRF	1
3	EVAC-CAP	1

EVAC-DBL-L

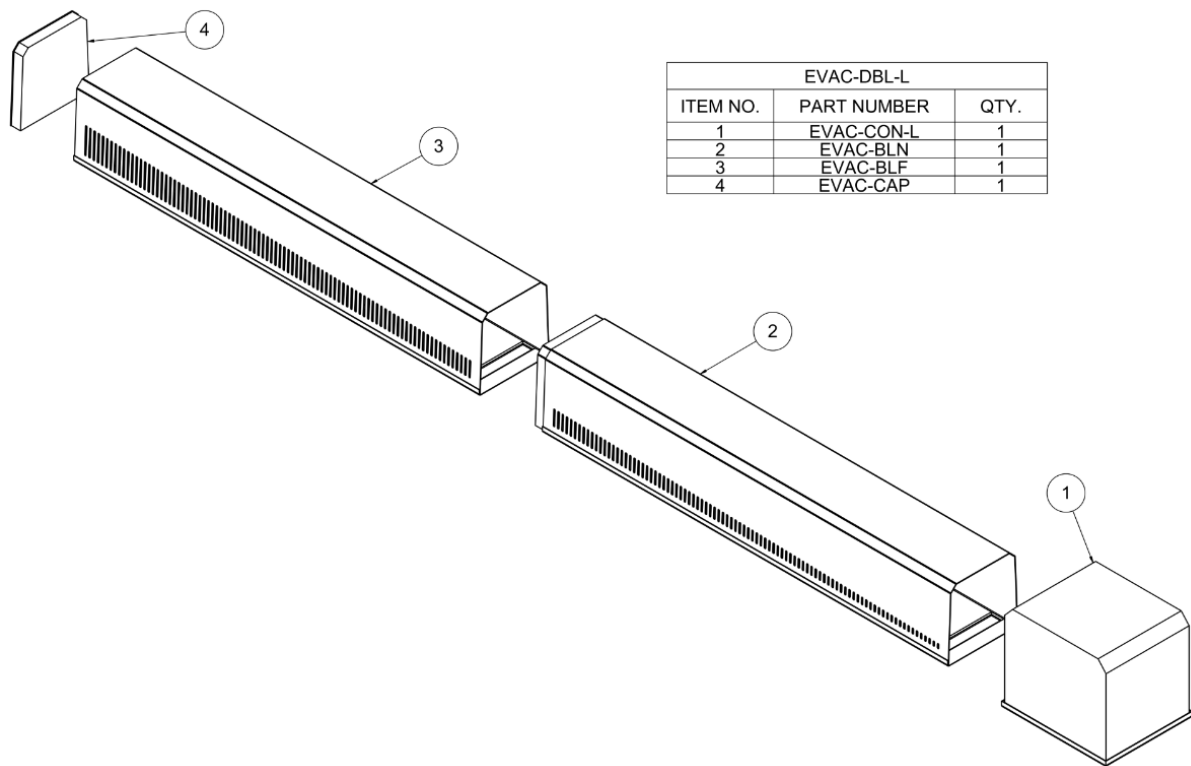

EVAC-DBL-R

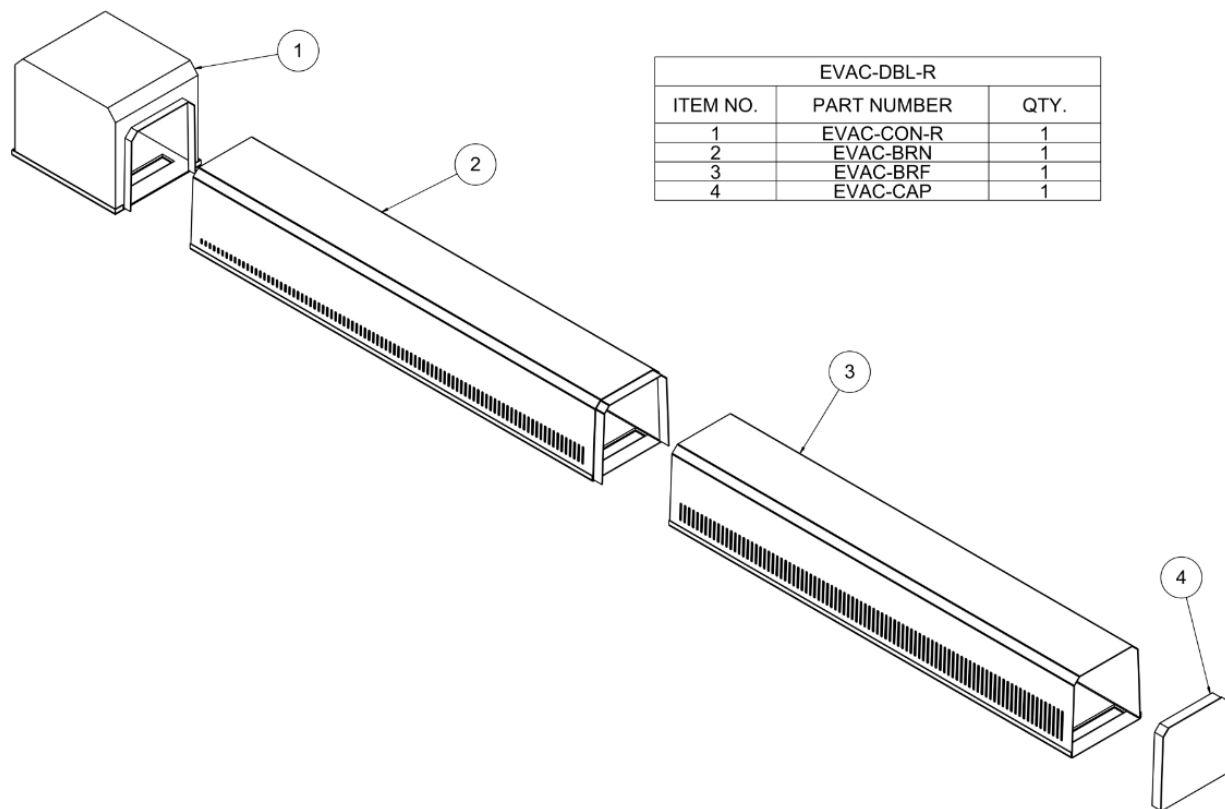

## EVAC-DBL-C

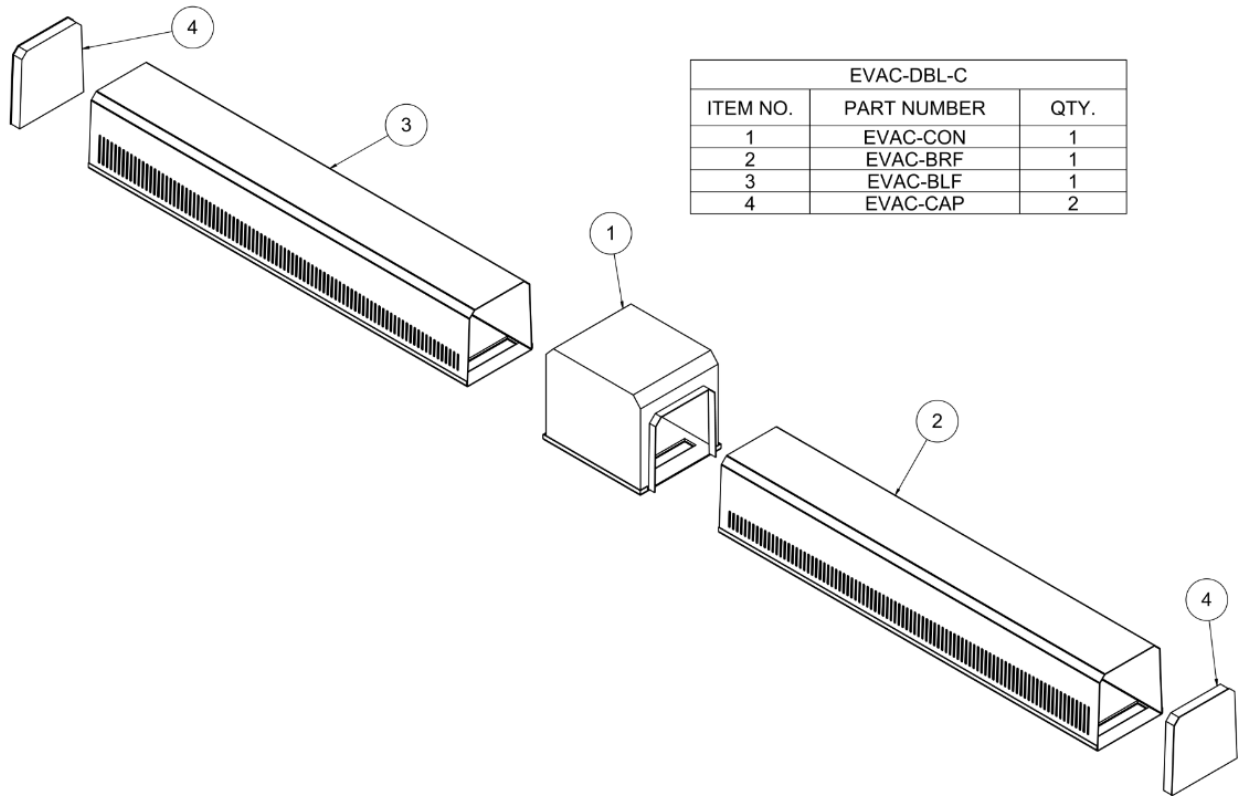

## EVAC-TRL-L

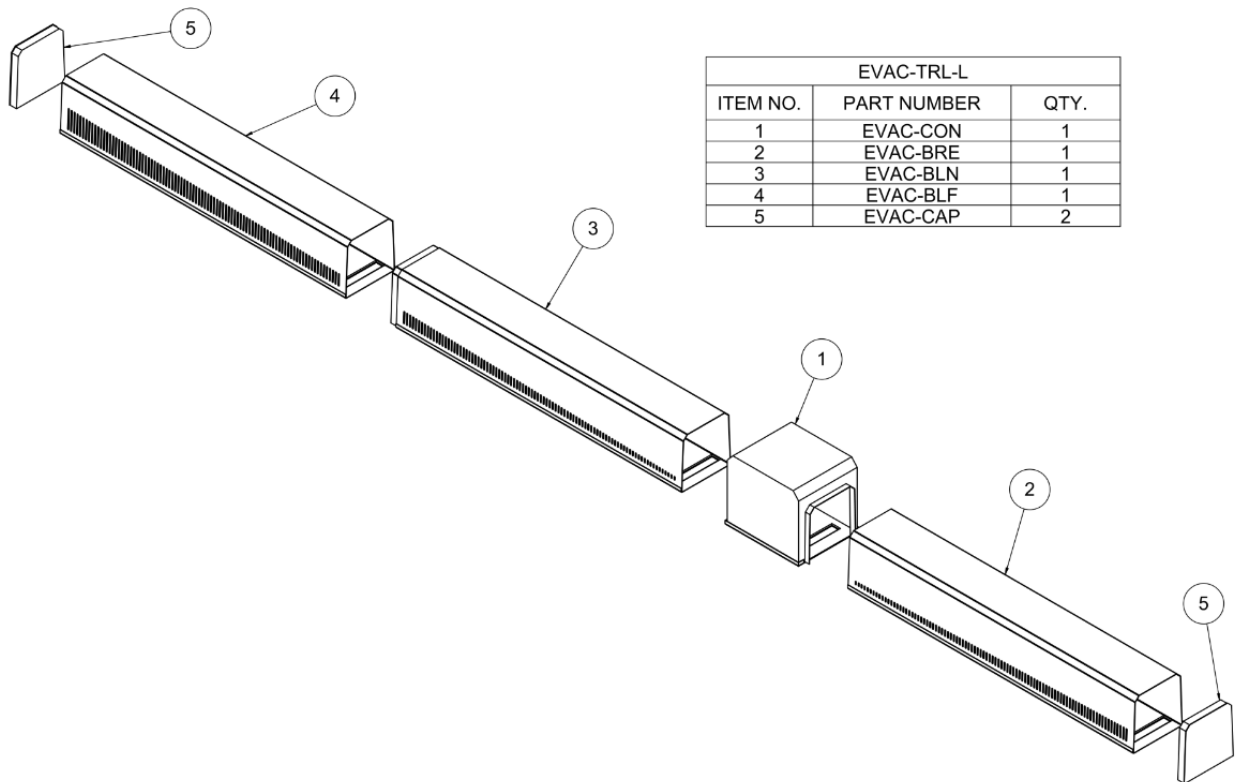

## EVAC-TRL-R

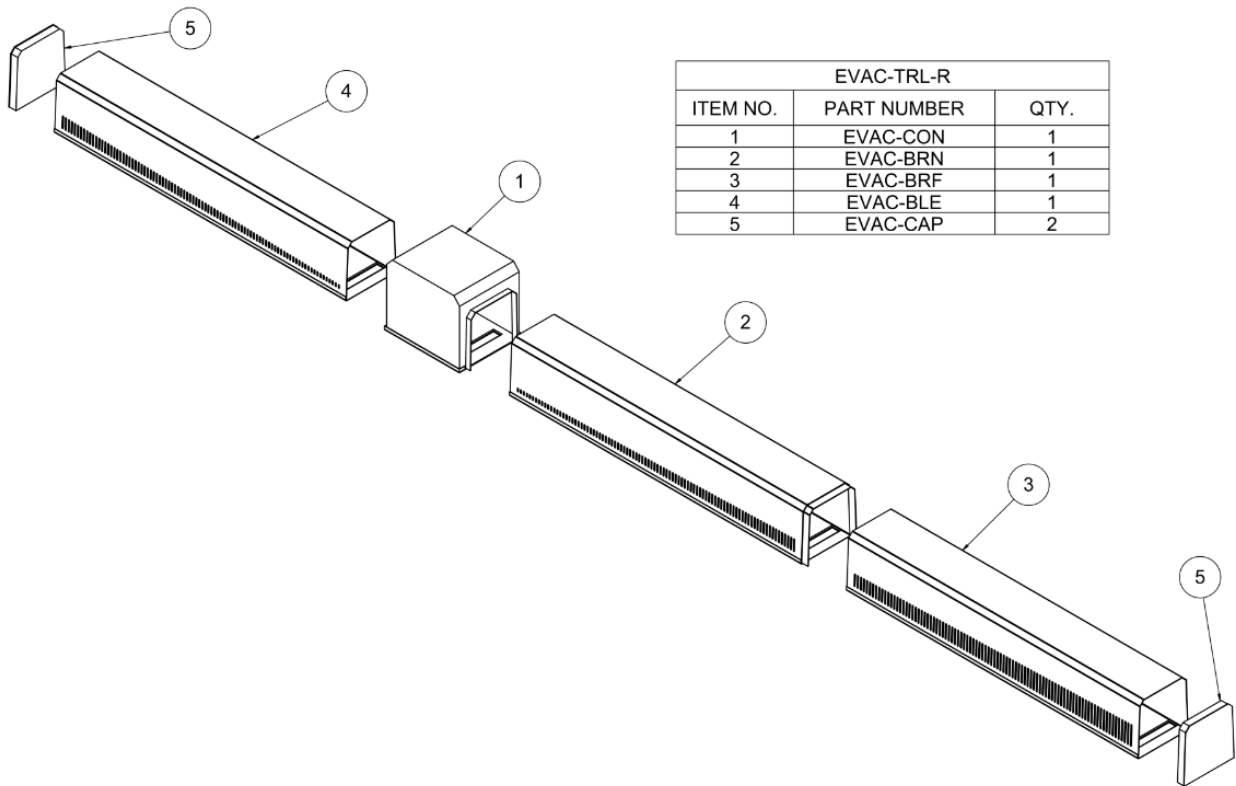

## EVAC -QUAD

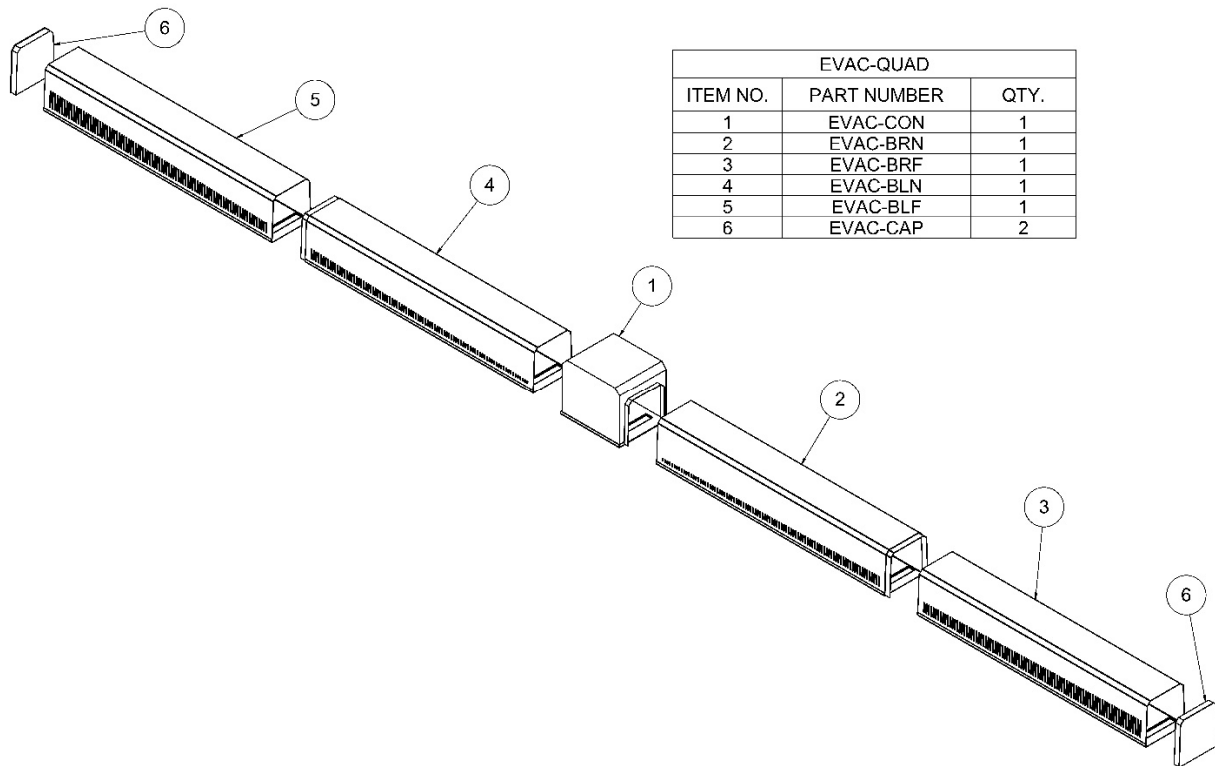





**Optimizing Solutions Through Superior Dehumidification Technology**

N120 W18485 Freistadt Road • Germantown, WI 53022 • E-mail: [info@desert-aire.com](mailto:info@desert-aire.com)

---

Ph: (262) 946-7400 • Fax: (262) 946-7401 • Website: [www.desert-aire.com](http://www.desert-aire.com)